

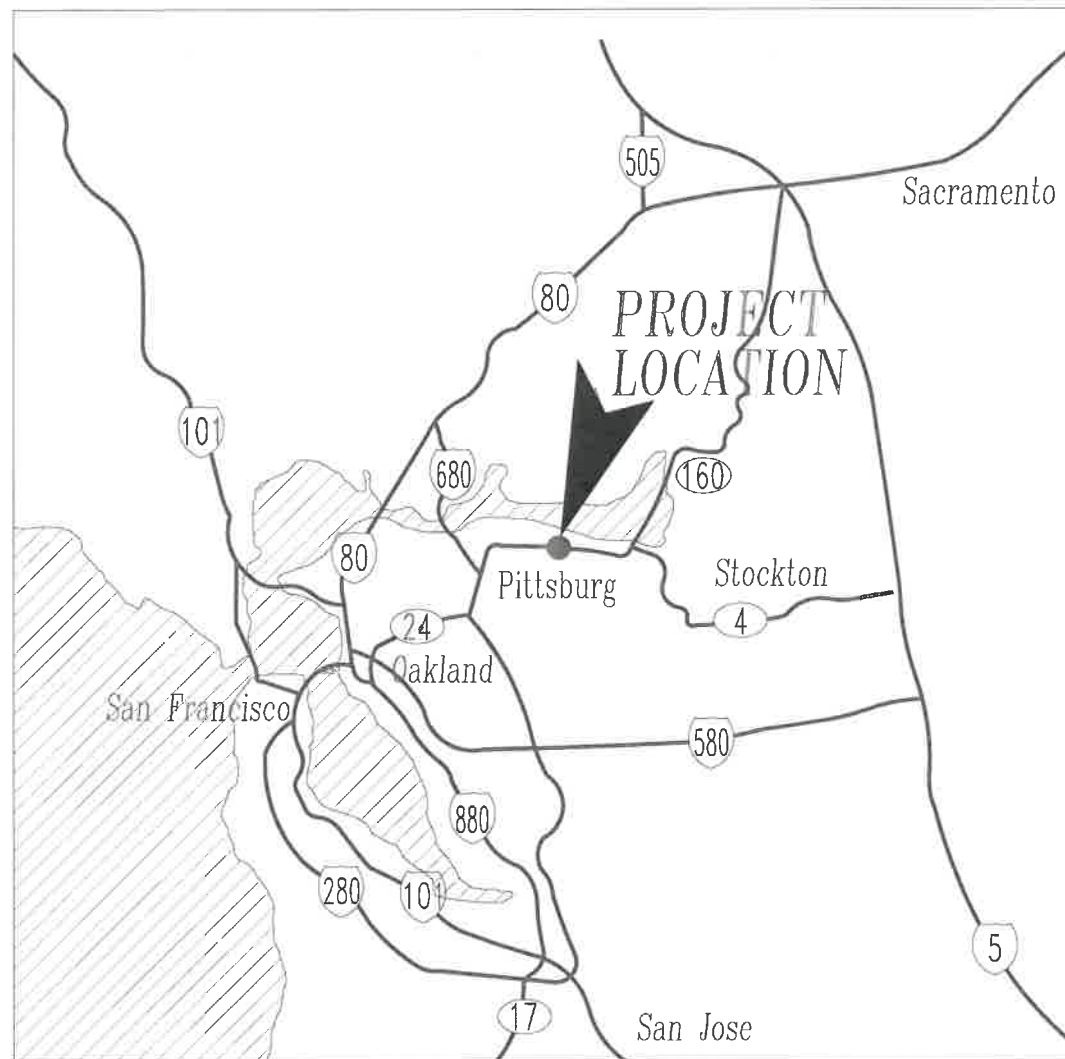

CITY OF PITTSBURG

ENGINEERING DIVISION PROJECT NO. 2050 SAFE ROUTES TO SCHOOL



LOCATION MAP
NTS

THE CITY COUNCIL OF THE CITY OF PITTSBURG

SHANELLE SCALES-PRESTON, MAYOR
JUAN ANTONIO BANALES, VICE MAYOR
JELANI KILLINGS, COUNCIL MEMBER
DIONNE ADAMS, COUNCIL MEMBER
ANGELICA LOPEZ, COUNCIL MEMBER

GARRETT EVANS, CITY MANAGER
ALICE E. EVENSON, CITY CLERK
JOHN SAMUELSON, PUBLIC WORKS DIRECTOR/CITY ENGINEER

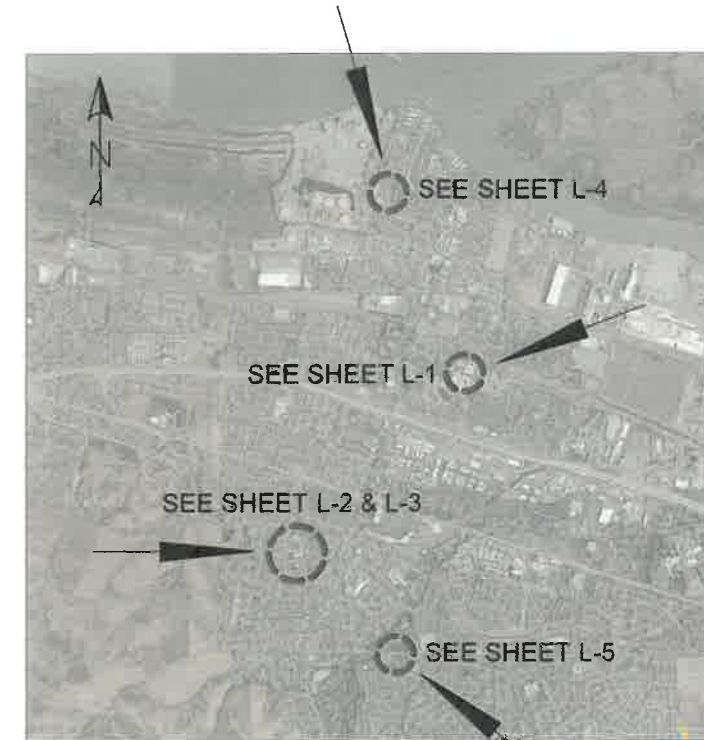

VICINITY MAP
NTS

SHEET INDEX

SHT. NO.	DWG. NO.	DRAWING TITLE
1	T-1	TITLE SHEET
2	G-1	GENERAL NOTES & ABBREVIATIONS
3-7	L-1 TO L-5	LAYOUT PLANS
8-9	CD-1 TO CD-2	CIVIL DETAILS



PREPARED UNDER THE DIRECTION OF:

JOHN SAMUELSON
REG. 087734



PROJECT NO. 2050
SAFE ROUTES TO SCHOOL
TITLE SHEET

BY	DESCRIPTION	DATE	REV
DRAWN: SR			
CHECKED: DJ			
REVIEWED: JS		9/14/23	
DATE			SCALE: N/A

DATE	REV	DESCRIPTION

SHEET:
1 OF 9

SHEET NO.
T-1

GENERAL NOTES

- ALL DRAWINGS AND SPECIFICATIONS ARE CONSIDERED PART OF THE CONTRACT DOCUMENTS. THE CONTRACTOR SHALL BE RESPONSIBLE FOR REVIEW AND COORDINATION OF ALL DRAWINGS AND SPECIFICATIONS PRIOR TO CONSTRUCTION. ANY DISCREPANCIES THAT OCCUR SHALL BE BROUGHT TO THE ATTENTION OF THE ENGINEER PRIOR TO THE START OF CONSTRUCTION SO THAT A CLARIFICATION MAY BE ISSUED. WORK NOT CONFORMING TO THE CONTRACT DOCUMENTS SHALL BE CORRECTED BY THE CONTRACTOR AT THE CONTRACTOR'S SOLE EXPENSE AND NO COST TO THE CITY.
- THE CONTRACTOR SHALL, IN ACCORDANCE WITH GENERALLY ACCEPTED PROFESSIONAL CONTRACTING PRACTICES, ASSUME SOLE AND COMPLETE RESPONSIBILITY AND LIABILITY FOR THE SAFETY CONDITIONS OF THE PROJECT SITE AND THE SAFE CONSTRUCTION OF THE CONTRACTED IMPROVEMENTS. SAFE PROJECT CONDITIONS SHALL INCLUDE THE CONTINUOUS SAFETY OF ALL WORKERS, PEDESTRIANS AND CYCLISTS THAT MAY BE ALLOWED ACCESS TO THE PROJECT SITE(S) DURING CONSTRUCTION. SAFE PROJECT CONDITIONS SHALL ALSO INCLUDE SAFE INTERACTIONS BETWEEN VEHICLES UTILIZING THE STREET ADJACENT TO THE PROJECT SITE AND THE OVERALL PROJECT SITE ITSELF. THESE PLANS DO NOT INCLUDE THE NECESSARY COMPONENTS TO ENSURE THE SAFE WORK ENVIRONMENTS DESCRIBED ABOVE. IT IS THE CONTRACTOR'S SOLE RESPONSIBILITY TO DETERMINE THE NECESSARY SAFETY COMPONENTS REQUIRED, DEPLOY THOSE COMPONENTS, AND FULLY MAINTAIN THE COMPONENTS DURING THE ENTIRE COURSE OF THE CONTRACTED WORK.
- THE CONTRACTOR SHALL AT ALL TIMES COMPLY WITH THE CONSTRUCTION SAFETY ORDERS AS SET-FORTH IN THE CALIFORNIA CODE OF REGULATIONS.
- THE CONTRACTOR SHALL AT ALL TIMES COMPLY WITH THE NATIONAL POLLUTION DISCHARGE ELIMINATION SYSTEM (NPDES) WATER POLLUTION CONTROL BEST MANAGEMENT PRACTICES (BMP).
- THE CONTRACTOR SHALL AT ALL TIMES COMPLY WITH THE CITY STANDARD PLANS AND SPECIFICATIONS.
- THESE PROJECT PLANS DO NOT NECESSARILY SHOW EACH AND EVERY UNDERGROUND FACILITY WITHIN THE PROJECT BOUNDARIES. THE CONTRACTOR IS SOLELY RESPONSIBLE TO VERIFY THE EXACT LOCATION AND DEPTH OF ALL EXISTING UTILITIES WITHIN THE HORIZONTAL AND VERTICAL LIMITS OF THE WORK AREA PRIOR TO COMMENCING ANY EXCAVATION. THE CONTRACTOR SHALL NOTIFY UNDERGROUND SERVICE ALERT AT (800) 227-2600 OR 811 NO FEWER THAN TWO WORKING DAYS, BUT NOT IN EXCESS OF 14 CALENDAR DAYS PRIOR TO COMMENCING EXCAVATION.
- THE CONTRACTOR SHALL DELINEATE WITH WHITE PAINT OR OTHER SUITABLE MARKINGS THE AREA TO BE EXCAVATED. CONTACTING U.S.A. DOES NOT RELIEVE THE CONTRACTOR FROM THE CONTRACTOR'S RESPONSIBILITY TO DETERMINE THE EXACT LOCATION AND DEPTH OF SUBSURFACE INSTALLATIONS. POTENTIAL SHALLOW UTILITIES NOT PER STANDARD INSTALL COULD BE FOUND.
- SERVICE LATERALS AND APPURTENANCES ARE NOT SHOWN ON THE PLANS. CONTRACTOR IS SOLELY RESPONSIBLE TO DETERMINE THE EXACT LOCATION AND DEPTH OF EXISTING SERVICE LATERALS OR APPURTENANCES WHENEVER THE PRESENCE OF SUCH ON THE SITE OF THE CONSTRUCTION PROJECT CAN BE INFERRED FROM THE PRESENCE OF OTHER VISIBLE FACILITIES, SUCH AS BUILDINGS, METER AND JUNCTION BOXES, LOCATED ON OR ADJACENT TO THE SITE OF THE CONSTRUCTION OR OTHERWISE WHERE MAIN OR TRUNKLINES ARE SHOWN ON THE PLANS OR INFERRED.

ABBREVIATIONS

AB	AGGREGATE BASE
AC	ASPHALT CONCRETE
BEG	BEGINNING
CB	CURB
CG	CURB AND GUTTER
CONC	CONCRETE
CY	CUBIC YARD
ID	INNER DIAMETER
MAX	MAXIMUM
MIN	MINIMUM
NTS	NOT TO SCALE
PCC	PORTLAND CEMENT CONCRETE
RC	RELATIVE COMPACTION
RRFB	RECTANGULAR RAPID FLASHING BEACON
SF	SQUARE FOOT/FEET
TYP	TYPICAL

- THE FACT THAT ANY UNDERGROUND FACILITY IS NOT SHOWN UPON THE PLANS SHALL NOT RELIEVE THE CONTRACTOR OF THE RESPONSIBILITY UNDER SECTION 8 1.10, "UTILITY AND NON HIGHWAY FACILITIES." IT SHALL BE CONTRACTOR'S SOLE RESPONSIBILITY, PURSUANT THERETO, TO ASCERTAIN THE LOCATION OF THOSE UNDERGROUND IMPROVEMENTS OR FACILITIES WHICH MAY BE SUBJECTED TO DAMAGE BY REASON OF THE CONTRACTOR'S OPERATIONS.
- UNLESS OTHERWISE INDICATED THERMOPLASTIC SHALL BE USED FOR ALL LEGENDS, MARKINGS, TRAFFIC LINES, LIMIT LINES, AND CROSSWALKS.
- THE CONTRACTOR SHALL BE SOLELY RESPONSIBLE FOR ANY DAMAGES TO THE SITE OR THE SURROUNDING AREA AS A RESULT OF THE CONTRACTOR'S WORK OR OPERATIONS. EXISTING CURB AND GUTTER, TRAFFIC LINES AND MARKINGS, OR OTHER IMPROVEMENTS THAT ARE DAMAGED OR DISPLACED BY THE CONTRACTOR SHALL BE REPLACED AT THE CONTRACTOR'S SOLE EXPENSE.
- TRAFFIC CONTROL DURING CONSTRUCTION SHALL BE THE CONTRACTOR'S RESPONSIBILITY. ALL SIGNS AND TRAFFIC CONTROL DEVICES SHALL BE IN ACCORDANCE WITH THE LATEST EDITION OF THE CALIFORNIA MANUAL ON UNIFORM TRAFFIC CONTROL DEVICES.
- CONTRACTOR SHALL PROVIDE FOR CONTINUOUS INGRESS AND EGRESS TO ALL PRIVATE PROPERTIES ADJACENT TO THE WORK THROUGHOUT THE PERIOD OF CONSTRUCTION UNLESS OTHERWISE APPROVED BY THE CITY.
- ALL STREET MONUMENTS AND OTHER PERMANENT MONUMENTS DISTURBED DURING CONSTRUCTION SHALL BE REPLACED BY THE CONTRACTOR, AT THE CONTRACTOR'S SOLE EXPENSE. BEFORE THE IMPROVEMENTS ARE ACCEPTED BY THE CITY, REPLACEMENT SHALL BE MADE UNDER THE DIRECTION OF A LICENSED PROFESSIONAL LAND SURVEYOR.
- ELEMENTS OF WORK FOR SIDEWALK FLAG DEMO SHALL BE FROM CONTROL JOINT TO CONTROL JOINT AND BACK OF CURB TO NEAREST CONTROL JOINT.



PREPARED UNDER THE DIRECTION OF:
 Date: 9/14/23
 JOHN SAMUELSON
 PCE 087734



PROJECT NO. 2050
 SAFE ROUTES TO SCHOOL
 GENERAL NOTES AND ABBREVIATIONS

BY	DRAWN: SR	CHECKED: DJ	REVIEWED: JS	DATE: 9/14/23	SCALE: N/A
----	-----------	-------------	--------------	---------------	------------

DATE	REV	DESCRIPTION

SHEET:
 2 OF 9
 SHEET NO.
 G-1

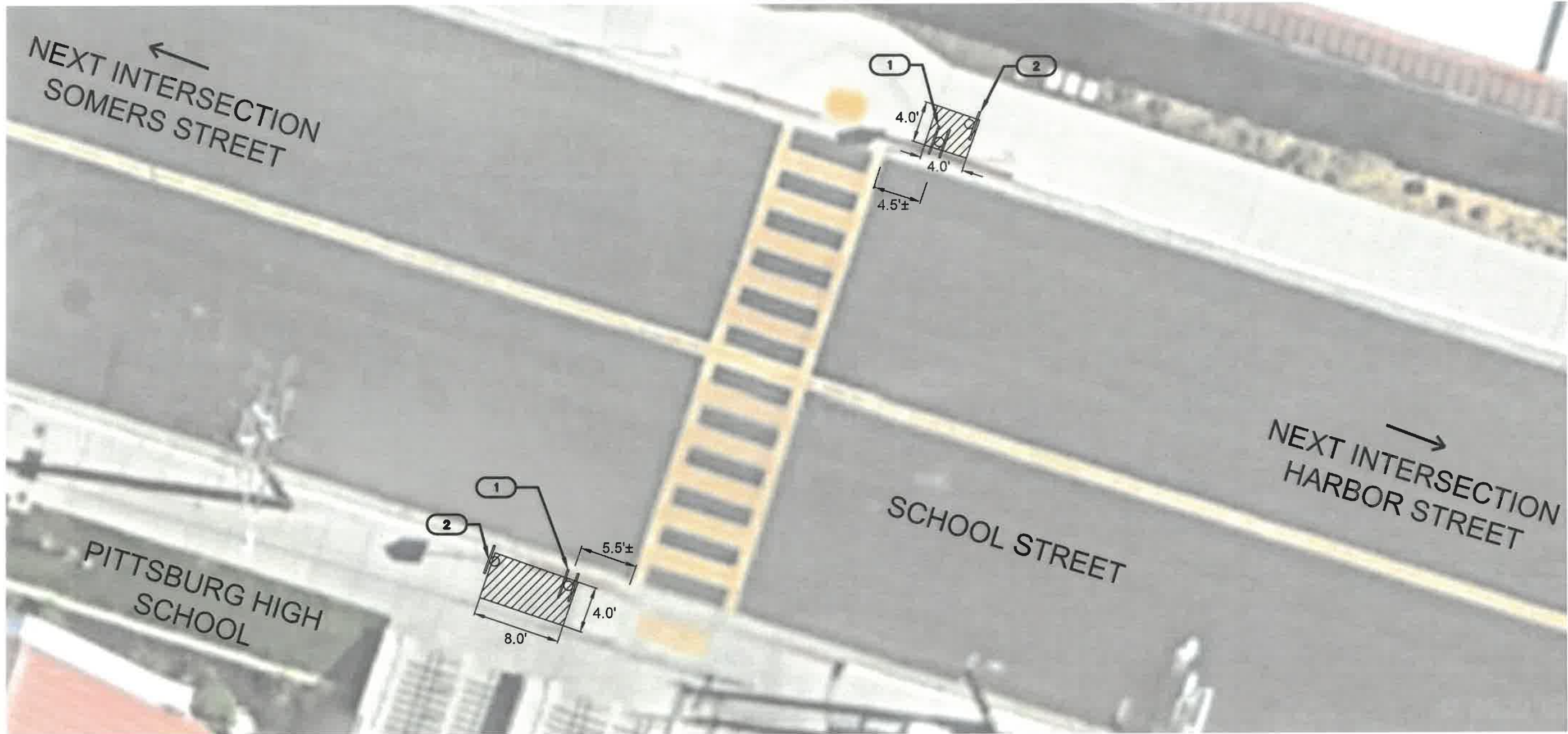



PLAN
NOT TO SCALE



NOTES:

1. WHEN PLANNED, CONSTRUCTION OPERATIONS MAY TEMPORARILY OBSTRUCT OR BLOCK A DRIVEWAY DURING THE SPECIFIED WORK HOURS, CONTRACTOR SHALL PROVIDE OWNER/TENANTS WRITTEN NOTICE 72 HOURS PRIOR TO PLANNED CONSTRUCTION. PROOF OF NOTICE WILL BE PROVIDED TO THE CITY. DRIVEWAY SHALL BE ACCESSIBLE TO THE OWNER /TENANTS AT ALL TIMES.
2. RRFBS SHALL BE MOUNTED ON 2" GALVANIZED STEEL POLES AS SHOWN ON SHEET CD-1, DETAIL 1. THE RRFB WITH SOLAR PANELS, SIGNS, AND CONCRETE FOOTING SHALL BE CONSTRUCTED AS SHOWN ON DETAIL 1. POLES SHALL BE PLACED A STANDARD DISTANCE OF 18" FROM THE FACE OF CURB.
3. INSTALL RRFBS WITH SOLAR PANELS (FACING SOUTH), PEDESTRIAN CROSSING SIGN, POLE, AND FOOTING.
4. SALVAGE EXISTING PEDESTRIAN CROSSING SIGNS AND DELIVER TO CORPORATION YARD AT 357 EAST 12TH ST. CALL (925) 252-4936 TO COORDINATE DROP OFF.
5. ALL WORK LOCATIONS TO BE VERIFIED IN THE FIELD BY ENGINEER. CONTRACTOR SHALL COORDINATE WITH CITY REPRESENTATIVE BEFORE ANY WORK BEGINS.
6. SIDEWALK FLAG DEMOLITION SHALL BE FROM BACK OF CURB AND NEAREST CONTROL JOINT TO NEAREST CONTROL JOINT. LOCATIONS TO BE CONFORMED IN THE FIELD BY ENGINEER. SEE "CONCRETE SURFACE IMPROVEMENTS" SPECIFICATIONS, DETAIL 3 SHEET CD-1, AND DETAIL 4 SHEET CD-2 FOR ALL SIDEWALK WORK.
7. COORDINATE WITH PUBLIC WORKS DEPARTMENT FOR PROCUREMENT OF RRFBS. CALL (925) 252-4936 TO COORDINATE PICK UP.
8. LOCATION DIMENSIONS OF RRFBS SHALL BEGIN AT EDGE OF CROSSWALK STRIPE.

LEGEND:

-  REMOVE AND REPLACE EXISTING SIDEWALK FLAG, SEE NOTE 5 & 6.
-  REMOVE EXISTING SIGN, POLE, AND FOUNDATION. INSTALL NEW RRFB, SOLAR PANEL, SIGNS POLE, AND FOUNDATION. LOCATIONS SHALL BE VERIFIED IN THE FIELD BY CITY REPRESENTATIVE/ENGINEER. SEE NOTES 2 & 4.
-  EXISTING SIGN, POLE, AND FOUNDATION.

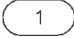
KEY NOTES:

-  1 INSTALL RRFB FURNISHED BY PUBLIC WORKS, SEE NOTES 2, 3, 7 & 8
-  2 REMOVE EXISTING SIGN POLE AND FOUNDATION, SEE NOTE 4



PREPARED UNDER THE DIRECTION OF:
JOHN SAMUELSON
No. C87734
Date: 9/14/23
PCE: C87734



PROJECT NO. 2050
SAFE ROUTES TO SCHOOL
SCHOOL STREET LAYOUT PLANS

BY: DRAWN: SR
CHECKED: DJ
REVIEWED: JS
DATE: 9/14/23
SCALE: N/A

DATE	REV	DESCRIPTION

SHEET:
3 OF 9
SHEET NO.
L-1

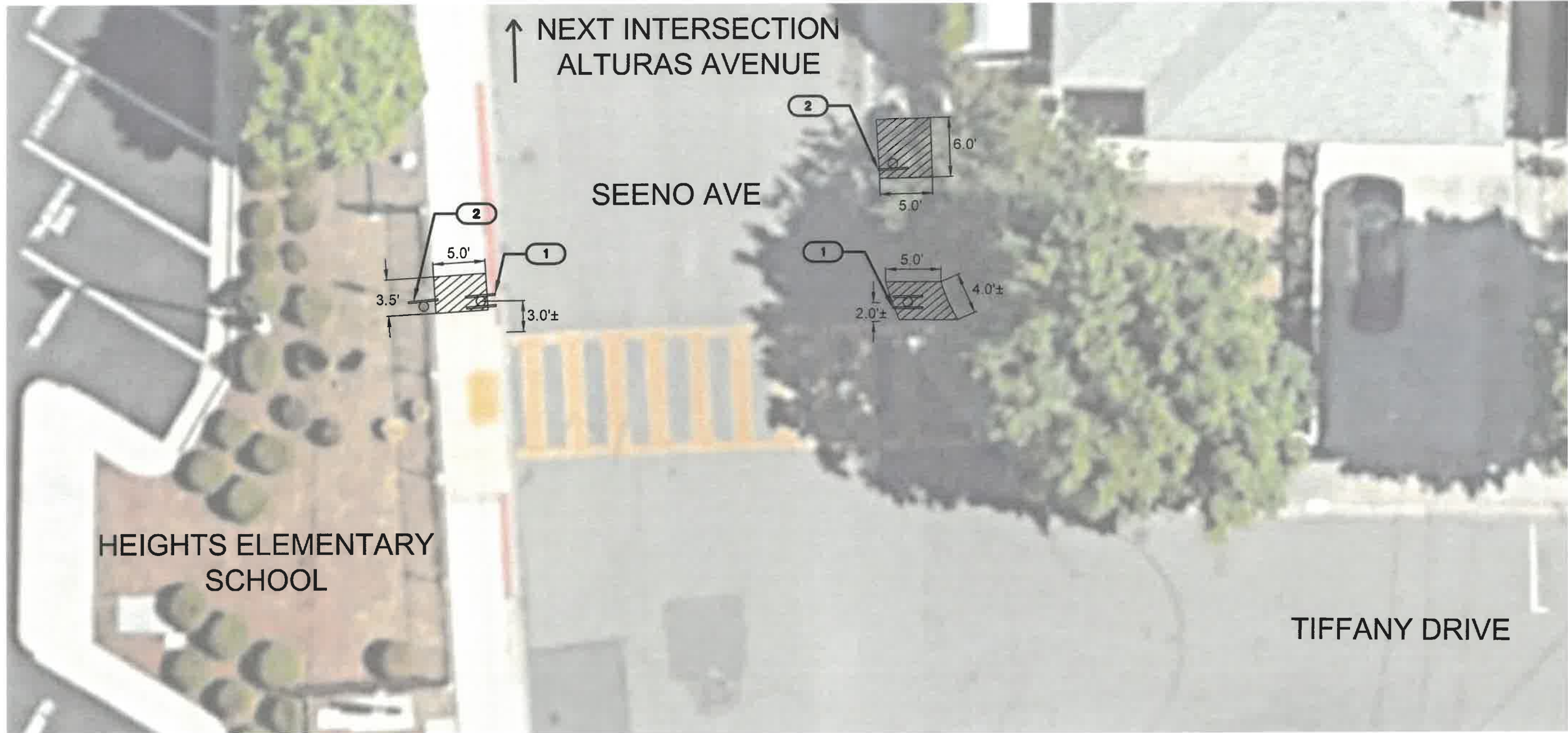

↑ NEXT INTERSECTION
ALTURAS AVENUE

SEENO AVE

HEIGHTS ELEMENTARY
SCHOOL

TIFFANY DRIVE

PLAN
NOT TO SCALE

LEGEND:



REMOVE AND REPLACE EXISTING SIDEWALK FLAG, SEE NOTE 5 & 6



INSTALL NEW RRFB, SOLAR PANEL, SIGNS POLE, AND FOUNDATION. LOCATIONS SHALL BE VERIFIED IN THE FIELD BY CITY REPRESENTATIVE/ENGINEER. SEE NOTE 2.



EXISTING SIGN, POLE, AND FOUNDATION.

KEY NOTES:



INSTALL RRFBS FURNISHED BY PUBLIC WORKS, SEE NOTES 2, 3, 7 & 8



REMOVE EXISTING SIGN POLE AND FOUNDATION, SEE NOTE 4

NOTES:

1. WHEN PLANNED, CONSTRUCTION OPERATIONS MAY TEMPORARILY OBSTRUCT OR BLOCK A DRIVEWAY DURING THE SPECIFIED WORK HOURS, CONTRACTOR SHALL PROVIDE OWNER/TENANTS WRITTEN NOTICE 72 HOURS PRIOR TO PLANNED CONSTRUCTION. PROOF OF NOTICE WILL BE PROVIDED TO THE CITY. DRIVEWAY SHALL BE ACCESSIBLE TO THE OWNER /TENANTS AT ALL TIMES.
2. RRFBS SHALL BE MOUNTED ON GALVANIZED STEEL POLES AS SHOWN ON SHEET CD-1, DETAIL 1. THE RRFB WITH SOLAR PANELS, SIGNS, AND CONCRETE FOOTING SHALL BE CONSTRUCTED AS SHOWN ON DETAIL 1. POLES SHALL BE PLACED A STANDARD DISTANCE OF 18" FROM THE FACE OF CURB.
3. INSTALL RRFBS WITH SOLAR PANELS (FACING SOUTH), PEDESTRIAN CROSSING SIGN, POLE, AND FOOTING.
4. SALVAGE EXISTING PEDESTRIAN CROSSING SIGNS AND DELIVER TO CORPORATION YARD AT 357 EAST 12TH ST. CALL (925) 252-4936 TO COORDINATE DROP OFF.
5. ALL WORK LOCATIONS TO BE VERIFIED IN THE FIELD BY ENGINEER. CONTRACTOR SHALL COORDINATE WITH CITY REPRESENTATIVE BEFORE ANY WORK BEGINS.
6. SIDEWALK FLAG DEMOLITION SHALL BE FROM BACK OF CURB AND NEAREST CONTROL JOINT TO NEAREST CONTROL JOINT. LOCATIONS TO BE CONFORMED IN THE FIELD BY ENGINEER. SEE "CONCRETE SURFACE IMPROVEMENTS" SPECIFICATIONS, DETAIL 3 SHEET CD-1, AND DETAIL 4 SHEET CD-2 FOR ALL SIDEWALK WORK.
7. COORDINATE WITH PUBLIC WORKS DEPARTMENT FOR PROCUREMENT OF RRFBS. CALL (925) 252-4936 TO COORDINATE PICK UP.
8. LOCATION DIMENSIONS OF RRFBS SHALL BEGIN AT EDGE OF CROSSWALK STRIPE.



PREPARED UNDER THE DIRECTION OF:

9/14/23
Date
JOHN SAMUELSON
P.E. 087734



PROJECT NO. 2050
SAFE ROUTES TO SCHOOL
SEENO AVENUE LAYOUT PLANS

BY	DRAWN: SR
CHECKED:	DJ
REVIEWED:	JS
DATE:	9/14/23
SCALE:	N/A

DATE	REV	DESCRIPTION

SHEET:
4 OF 9
SHEET NO.
L-2

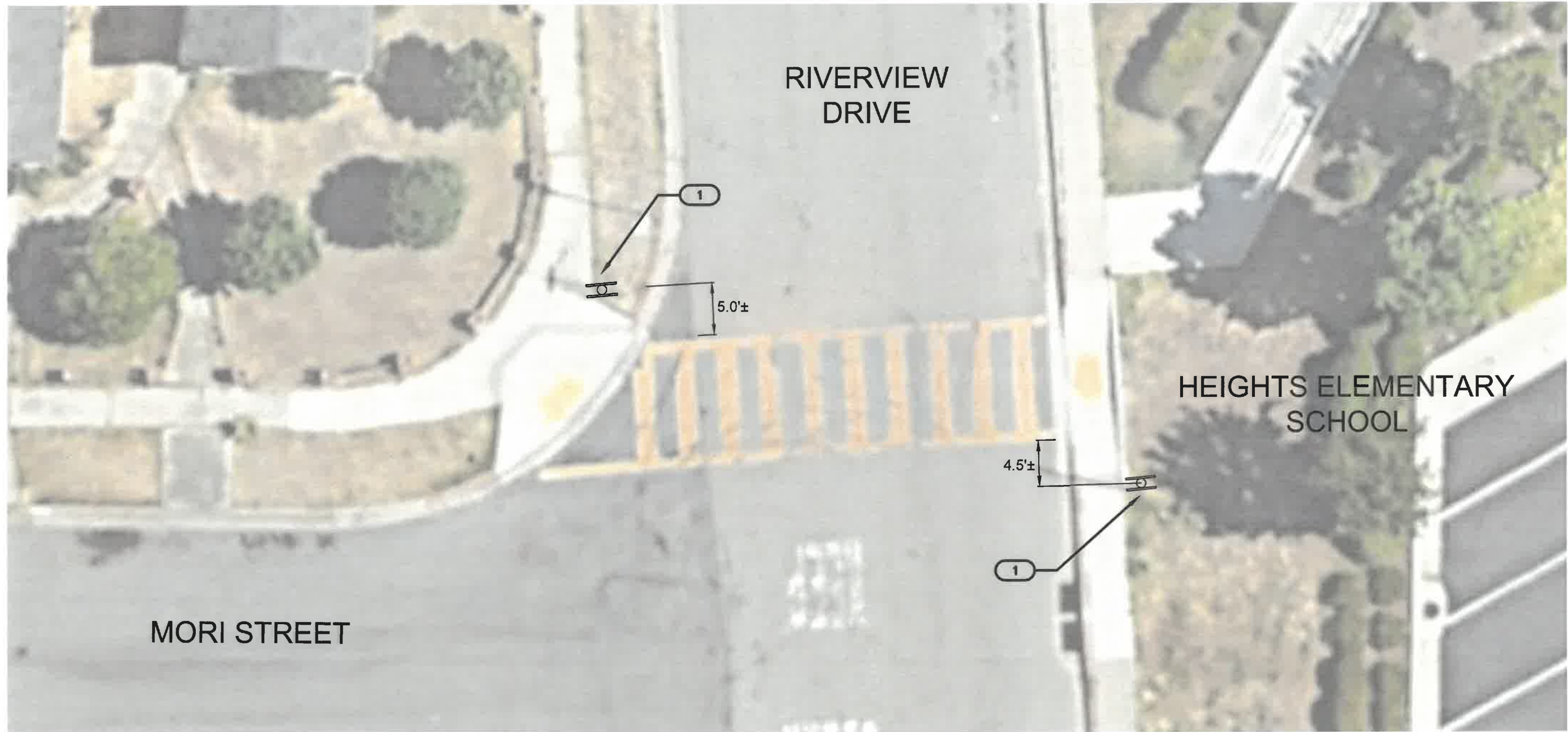

RIVERVIEW
DRIVE

HEIGHTS ELEMENTARY
SCHOOL

MORI STREET

PLAN
NOT TO SCALE

NOTES:

1. WHEN PLANNED, CONSTRUCTION OPERATIONS MAY TEMPORARILY OBSTRUCT OR BLOCK A DRIVEWAY DURING THE SPECIFIED WORK HOURS, CONTRACTOR SHALL PROVIDE OWNER/TENANTS WRITTEN NOTICE 72 HOURS PRIOR TO PLANNED CONSTRUCTION. PROOF OF NOTICE WILL BE PROVIDED TO THE CITY. DRIVEWAY SHALL BE ACCESSIBLE TO THE OWNER /TENANTS AT ALL TIMES.
2. RRFBS SHALL BE MOUNTED ON 2" GALVANIZED STEEL POLES AS SHOWN ON SHEET CD-1, DETAIL 1. THE RRFB WITH SOLAR PANELS, SIGNS, AND CONCRETE FOOTING SHALL BE CONSTRUCTED AS SHOWN ON DETAIL 1.
3. INSTALL RRFBS WITH SOLAR PANELS (FACING SOUTH), PEDESTRIAN CROSSING SIGN, POLE, AND FOOTING.
4. SALVAGE EXISTING PEDESTRIAN CROSSING SIGNS AND DELIVER TO CORPORATION YARD AT 357 EAST 12TH ST. CALL (925) 252-4936 TO COORDINATE DROP OFF.
5. ALL WORK LOCATIONS TO BE VERIFIED IN THE FIELD BY ENGINEER. CONTRACTOR SHALL COORDINATE WITH CITY REPRESENTATIVE BEFORE ANY WORK BEGINS.
6. SIDEWALK FLAG DEMOLITION SHALL BE FROM BACK OF CURB AND NEAREST CONTROL JOINT TO NEAREST CONTROL JOINT. LOCATIONS TO BE CONFORMED IN THE FIELD BY ENGINEER. SEE "CONCRETE SURFACE IMPROVEMENTS" SPECIFICATIONS AND DETAILS 3 & 4, SHEET CD-1 FOR ALL SIDEWALK WORK.
7. COORDINATE WITH PUBLIC WORKS DEPARTMENT FOR PROCUREMENT OF RRFBS. CALL (925) 252-4936 TO COORDINATE PICK UP.
8. LOCATION DIMENSIONS OF RRFBS SHALL BEGIN AT EDGE OF CROSSWALK STRIPE.

LEGEND:



REMOVE EXISTING SIGN, POLE, AND FOUNDATION. INSTALL NEW RRFB, SOLAR PANEL, SIGNS POLE, AND FOUNDATION. LOCATIONS SHALL BE VERIFIED IN THE FIELD BY CITY REPRESENTATIVE/ENGINEER. SEE NOTES 2 & 4.

KEY NOTES:



INSTALL RRFB FURNISHED BY PUBLIC WORKS, SEE NOTES 2, 3, 7 & 8



PREPARED UNDER THE DIRECTION OF:
 JOHN SAMUELSON
 No. CB7734
 Date: 9/14/23
 RCE: CB7734



PROJECT NO. 2050
 SAFE ROUTES TO SCHOOL
 RIVERVIEW DRIVE LAYOUT PLANS

BY	DRAWN: SR
CHECKED:	DJ
REVIEWED:	JS
DATE:	9/14/23
SCALE:	N/A

DATE	REV	DESCRIPTION

SHEET:
 5 OF 9
 SHEET NO.
 L-3

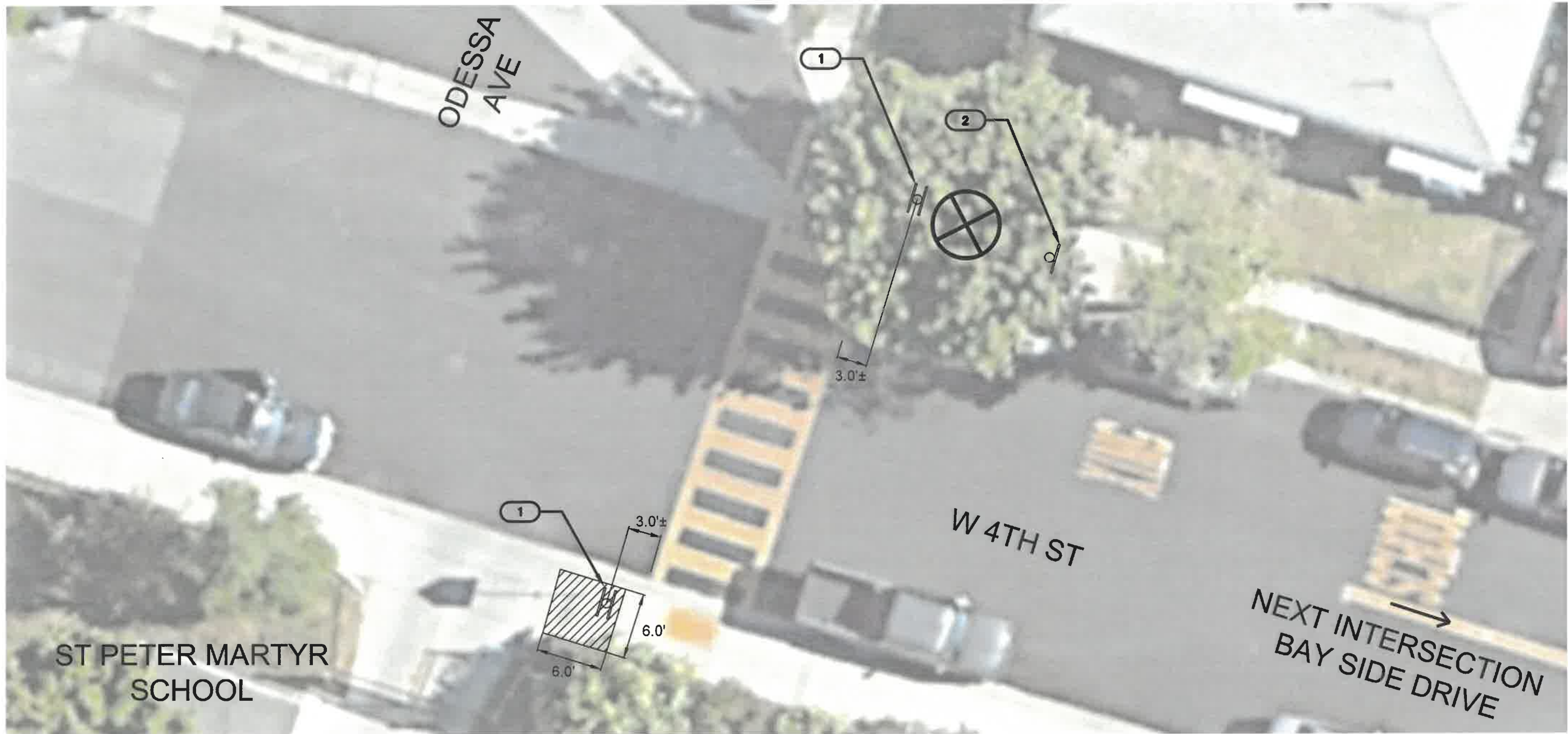





PLAN
NOT TO SCALE



NOTES:

1. WHEN PLANNED, CONSTRUCTION OPERATIONS MAY TEMPORARILY OBSTRUCT OR BLOCK A DRIVEWAY DURING THE SPECIFIED WORK HOURS, CONTRACTOR SHALL PROVIDE OWNER/TENANTS WRITTEN NOTICE 72 HOURS PRIOR TO PLANNED CONSTRUCTION. PROOF OF NOTICE WILL BE PROVIDED TO THE CITY. DRIVEWAY SHALL BE ACCESSIBLE TO THE OWNER /TENANTS AT ALL TIMES.
2. RRFBS SHALL BE MOUNTED ON 2" GALVANIZED STEEL POLES AS SHOWN ON SHEET CD-1, DETAIL 1. THE RRFB WITH SOLAR PANELS, SIGNS, AND CONCRETE FOOTING SHALL BE CONSTRUCTED AS SHOWN ON DETAIL 1. POLES SHALL BE PLACED A STANDARD DISTANCE OF 18" FROM THE FACE OF CURB.
3. INSTALL RRFBS WITH SOLAR PANELS (FACING SOUTH), PEDESTRIAN CROSSING SIGN, POLE, AND FOOTING.
4. SALVAGE EXISTING PEDESTRIAN CROSSING SIGNS AND DELIVER TO CORPORATION YARD AT 357 EAST 12TH ST. CALL (925) 252-4936 TO COORDINATE DROP OFF.
5. ALL WORK LOCATIONS TO BE VERIFIED IN THE FIELD BY ENGINEER. CONTRACTOR SHALL COORDINATE WITH CITY REPRESENTATIVE BEFORE ANY WORK BEGINS.
6. SIDEWALK FLAG DEMOLITION SHALL BE FROM BACK OF CURB AND NEAREST CONTROL JOINT TO NEAREST CONTROL JOINT. LOCATIONS TO BE CONFORMED IN THE FIELD BY ENGINEER. SEE "CONCRETE SURFACE IMPROVEMENTS" SPECIFICATIONS, DETAIL 3 SHEET CD-1, AND DETAIL 4 SHEET CD-2 FOR ALL SIDEWALK WORK.
7. COORDINATE WITH PUBLIC WORKS DEPARTMENT FOR PROCUREMENT OF RRFBS. CALL (925) 252-4936 TO COORDINATE PICK UP.
8. LOCATION DIMENSIONS OF RRFBS SHALL BEGIN AT EDGE OF CROSSWALK STRIPE.

LEGEND:

-  REMOVE AND REPLACE EXISTING SIDEWALK FLAG, SEE NOTES 5 & 6.
-  REMOVE EXISTING SIGN, POLE, AND FOUNDATION. INSTALL NEW RRFB, SOLAR PANEL, SIGNS POLE, AND FOUNDATION. LOCATIONS SHALL BE VERIFIED IN THE FIELD BY CITY REPRESENTATIVE/ENGINEER. SEE NOTES 2 & 4.
-  EXISTING SIGN, POLE, AND FOUNDATION.
-  REMOVE EXISTING TREE, SEE SPECIFICATIONS.

KEY NOTES:

-  INSTALL RRFB FURNISHED BY PUBLIC WORKS, SEE NOTES 2, 3, 7 & 8
-  REMOVE EXISTING SIGN POLE AND FOUNDATION, SEE NOTE 4



PREPARED UNDER THE DIRECTION OF:

JOHN SAMUELSON
No. 087734
Date



PROJECT NO. 2050
SAFE ROUTES TO SCHOOL
WEST 4TH STREET LAYOUT PLANS

BY: DRAWN: SR
CHECKED: DJ
REVIEWED: JS
DATE: 8/14/23
SCALE: N/A

DATE	REV	DESCRIPTION

SHEET:
6 OF 9
SHEET NO.
L-4

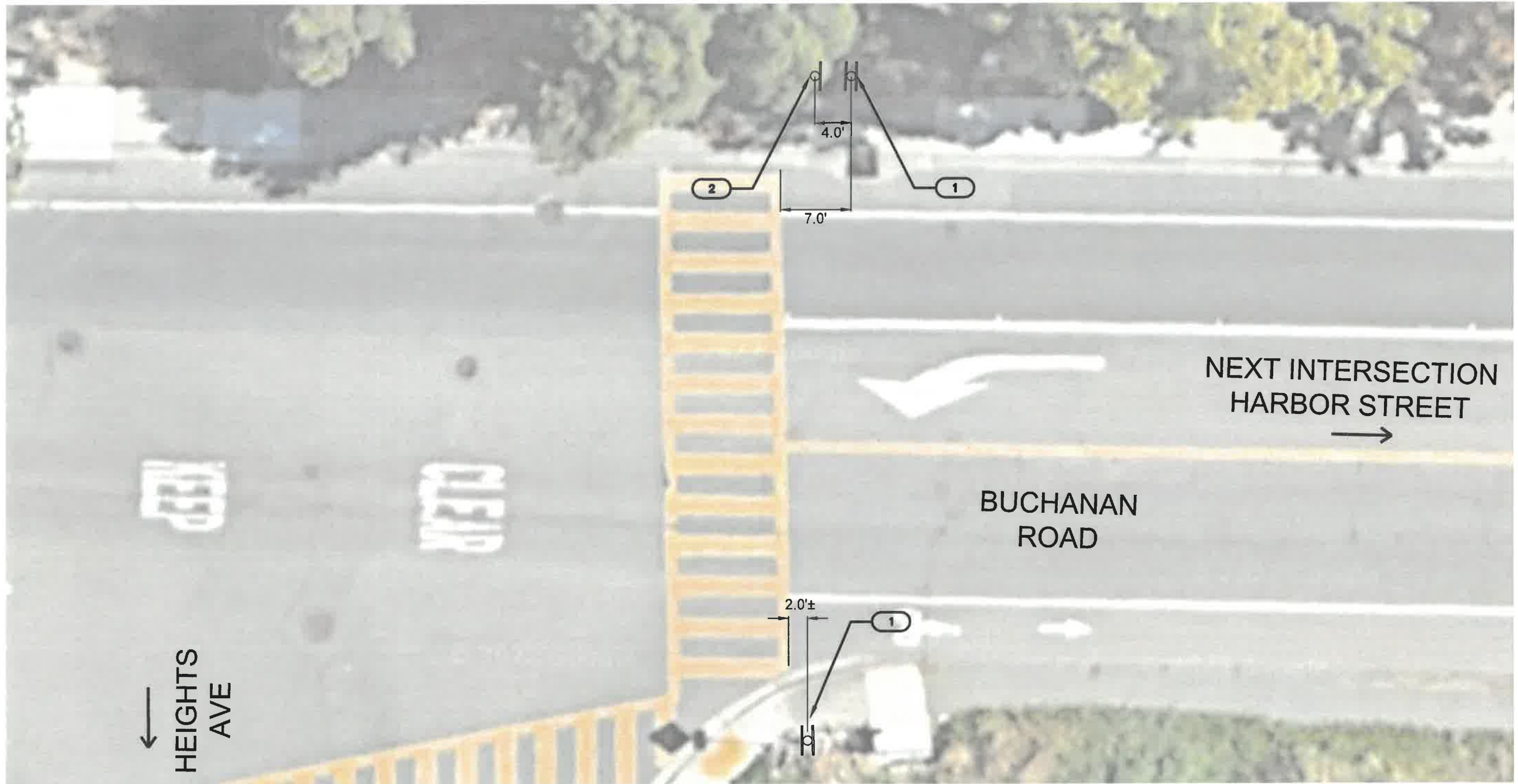

PLAN
NOT TO SCALE

NOTES:

1. WHEN PLANNED, CONSTRUCTION OPERATIONS MAY TEMPORARILY OBSTRUCT OR BLOCK A DRIVEWAY DURING THE SPECIFIED WORK HOURS, CONTRACTOR SHALL PROVIDE OWNER/TENANTS WRITTEN NOTICE 72 HOURS PRIOR TO PLANNED CONSTRUCTION. PROOF OF NOTICE WILL BE PROVIDED TO THE CITY. DRIVEWAY SHALL BE ACCESSIBLE TO THE OWNER /TENANTS AT ALL TIMES.
2. RRFBS SHALL BE MOUNTED ON 2" GALVANIZED STEEL POLES AS SHOWN ON SHEET CD-1, DETAIL 1. THE RRFB WITH SOLAR PANELS, SIGNS, AND CONCRETE FOOTING SHALL BE CONSTRUCTED AS SHOWN ON DETAIL 1.
3. INSTALL RRFBS WITH SOLAR PANELS (FACING SOUTH), PEDESTRIAN CROSSING SIGN, POLE, AND FOOTING.
4. SALVAGE EXISTING PEDESTRIAN CROSSING SIGNS AND DELIVER TO CORPORATION YARD AT 357 EAST 12TH ST. CALL (925) 252-4936 TO COORDINATE DROP OFF.
5. ALL WORK LOCATIONS TO BE VERIFIED IN THE FIELD BY ENGINEER. CONTRACTOR SHALL COORDINATE WITH CITY REPRESENTATIVE BEFORE ANY WORK BEGINS.
6. COORDINATE WITH PUBLIC WORKS DEPARTMENT FOR PROCUREMENT OF RRFBS. CALL (925) 252-4936 TO COORDINATE PICK UP.
7. LOCATION DIMENSIONS OF RRFBS SHALL BEGIN AT EDGE OF CROSSWALK STRIPE.

LEGEND:



REMOVE EXISTING SIGN, POLE, AND FOUNDATION. INSTALL NEW RRFB, SOLAR PANEL, SIGNS POLE, AND FOUNDATION. LOCATIONS SHALL BE VERIFIED IN THE FIELD BY CITY REPRESENTATIVE/ENGINEER. SEE NOTES 2 & 4.

EXISTING SIGN, POLE, AND FOUNDATION.

KEY NOTES:



INSTALL RRFB FURNISHED BY PUBLIC WORKS, SEE NOTES 2, 3, 6 & 7

REMOVE EXISTING SIGN POLE AND FOUNDATION, SEE NOTE 4



PREPARED UNDER THE DIRECTION OF:

JOHN SAMUELSON
P.E. 087734
Date: 9/14/23



PROJECT NO. 2050
SAFE ROUTES TO SCHOOL
BUCHANAN ROAD LAYOUT PLANS

BY: DRAWN: SR
CHECKED: DJ
REVIEWED: JS
DATE: 9/14/23
SCALE: N/A

DATE	REV	DESCRIPTION

SHEET:
7 OF 9
SHEET NO.
L-5

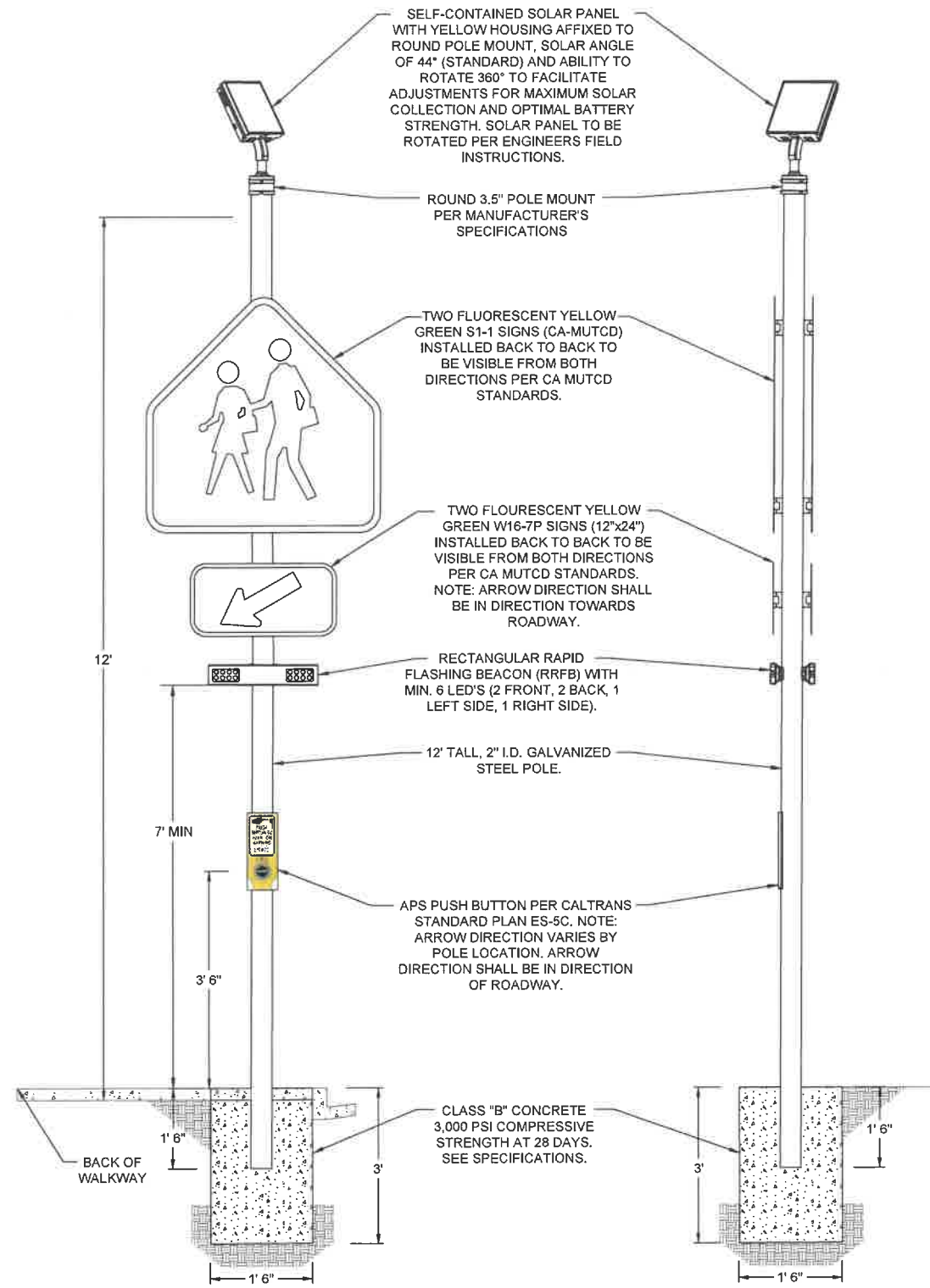

- NOTES:
1. GALVANIZED STEEL POLE, AND MATERIALS FOR THE FOOTING SHALL BE FURNISHED BY THE CONTRACTOR.
 2. RRFBS, SOLAR PANEL, AND SIGNS SHALL BE FURNISHED BY THE CITY OF PITTSBURG. COORDINATE WITH PUBLIC WORKS DEPARTMENT FOR PROCUREMENT OF RRFBS, SOLAR PANEL, AND SIGNS.
 3. LOCATIONS OF RRFBS TO BE VERIFIED IN THE FIELD BY CITY REPRESENTATIVE/ENGINEER.
 4. SEE APPENDIX E FOR RRFB CUT SHEET.

1 RRFB CONSTRUCTION DETAIL
SCALE: NTS

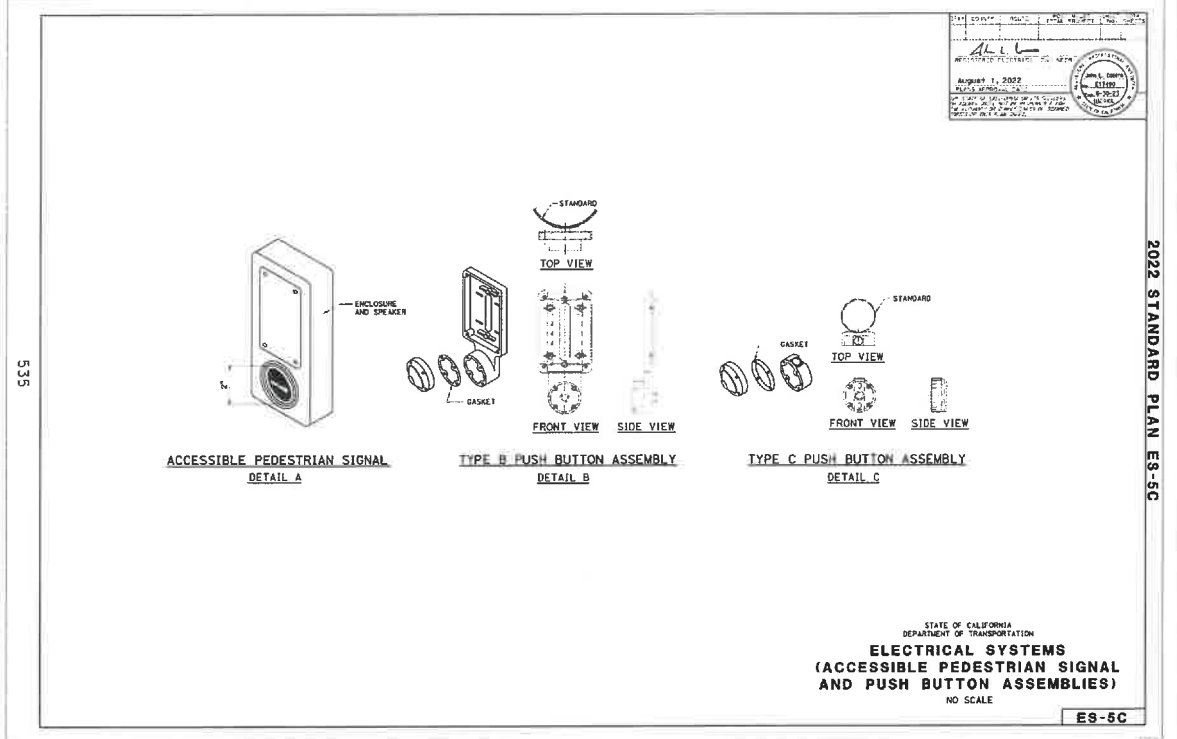

2 CALTRANS STANDARD DETAIL ES-5C
SCALE: NTS

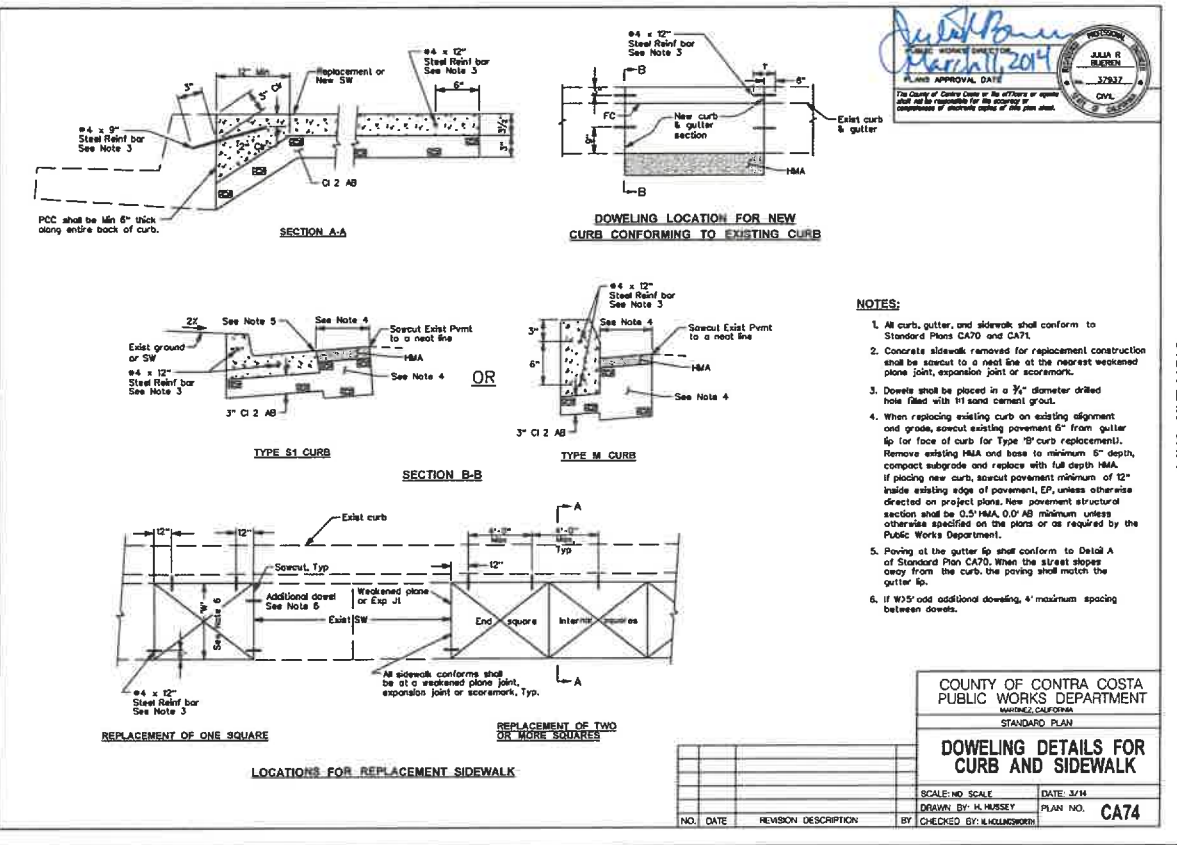

3 CONTRA COSTA COUNTY STD PLAN CA74
SCALE: NTS



PREPARED UNDER THE DIRECTION OF:
Date
JOHN SAMUELSON
P.E. CB7734



PROJECT NO. 2050
SAFE ROUTES TO SCHOOL
CIVIL DETAILS

DATE	REV	DESCRIPTION	BY	DATE	REV	DESCRIPTION

BY: DRAWN: SR
CHECKED: DJ
REVIEWED: JS
DATE: 9/14/23
SCALE: N/A

SHEET: 8 OF 9
SHEET NO. CD-1

2022 STANDARD PLAN ES-5C

Return to Table of Contents

STD. PLAN CA74

COUNTY OF CONTRA COSTA
PUBLIC WORKS DEPARTMENT
STANDARD PLAN
DOWELING DETAILS FOR
CURB AND SIDEWALK
SCALE: NO SCALE DATE: 3/11
DRAWN BY: K. HURSEY PLAN NO. CA74
CHECKED BY: K. HURSEY

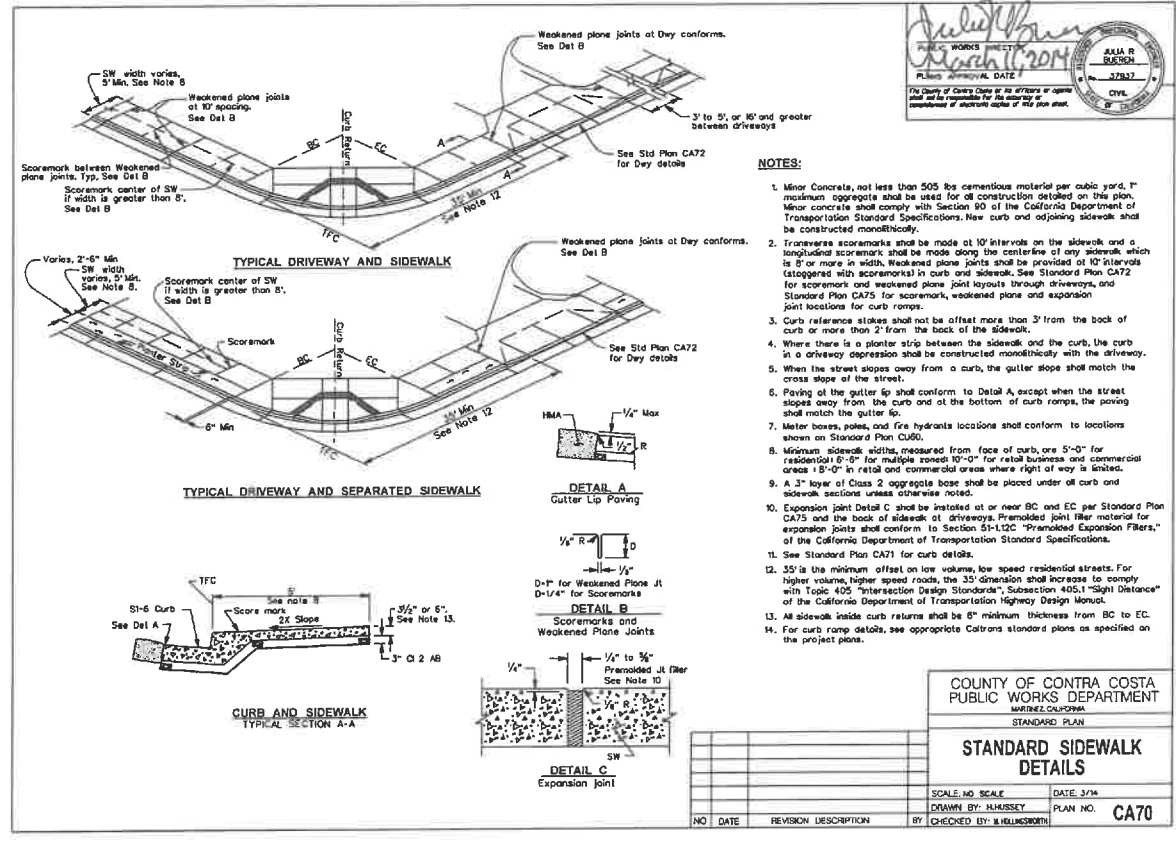

PUBLIC WORKS PROJECT

 PLAN APPROVAL DATE: 8/14/23

 JOHN SAMUELSON

 CIVIL ENGINEER

 No. C67734

 STATE OF CALIFORNIA

STD PLAN CA70

COUNTY OF CONTRA COSTA
PUBLIC WORKS DEPARTMENT
MARTINEZ, CALIFORNIA
STANDARD PLAN

STANDARD SIDEWALK DETAILS

SCALE: NO. SCALE DATE: 3/14
 DRAWN BY: J. HUSSEY PLAN NO. CA70
 CHECKED BY: J. HELLINGBORN

NO.	DATE	REVISION DESCRIPTION	BY	CHECKED BY

4 CONTRA COSTA COUNTY STD PLAN CA70
SCALE: NTS



PREPARED UNDER THE DIRECTION OF:

 JOHN SAMUELSON
 CIVIL ENGINEER
 No. C67734
 Date: 8/14/23



PROJECT NO. 2050
 SAFE ROUTES TO SCHOOL
 CIVIL DETAILS

BY	DRAWN: SR
	CHECKED: DJ
	REVIEWED: JS
	DATE: 8/14/23
	SCALE: N/A

DATE	REV	DESCRIPTION

SHEET:
 9 OF 9
 SHEET NO.
 CD-2